

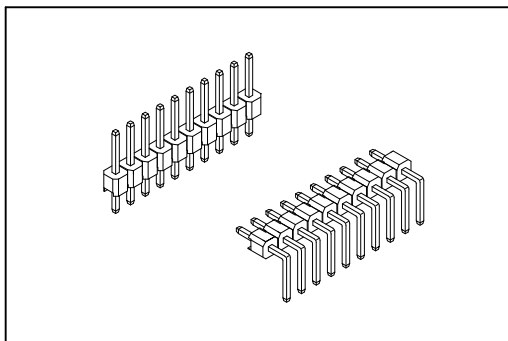

2011 Series

Pin Header 2.54mm(0.100")



Material:

Housing: Thermoplastic Polyester Glass Filled UL94V-0.

Contacts: Copper Alloy.

Electrical Characteristics:

Current Rating: 2 A.

Dielectric Withstanding Voltage: AC 1000V.

Insulator Resistance: 1000MΩ min.

Contact Resistance: 20mΩ max.

Operating Temperature: -40°C~+105°C.

Features:

- * Available in Straight, Right Angle and Press Fit
- * Side-to-side and end-to-end stackable.
- * Custom design offered.
- * Additional plating options available.

Mates with: 2006,2041,2042,2043,2044,2045

2047,2048,2049,4071

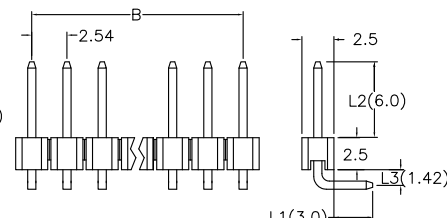
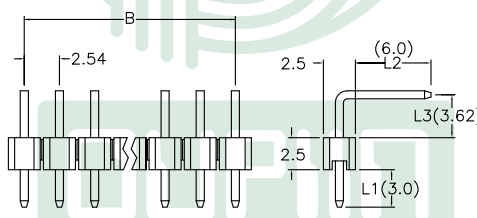
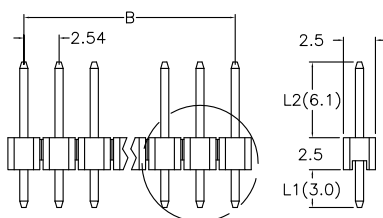
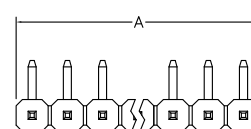
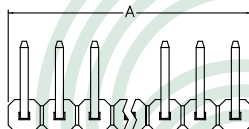
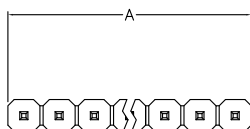

S: Straight

R: Right Angle Type 1

L: Right Angle Type 2

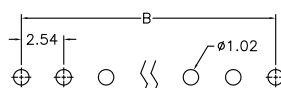
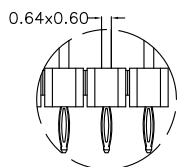
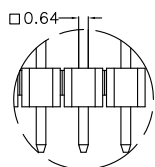

P.C. Board Layout

Dip Type

Press Fit Type

Position Dimension	2 Thru 40
A	2.54 X No. of Positions-0.25
B	2.54 X No. of Positions-2.54

Ordering information

2011-

1

X

40

G

00

S

P

B

Series

Single Row

No. of Pin Per Row

G: Gold Plated

00: G/F

S: Straight

R: Right Angle Type 1

L: Right Angle Type 2

Blank: Dip Type

P: Press Fit Type

B: Bulk Package

Custom Design: Straight (i.e. 2011-1 X 40 G00S-L1-L2); Right Angle (i.e. 2011-1X40G00R-L1-L2-L3 & 2011-1X40G00L-L1-L2-L3).

L1: Dip Length; L2: Mating Length; L3: Extended Length (6 Choices: 1.42mm, 1.97mm, 2.07mm, 2.32mm, 2.92mm, 3.62mm.).

* Consult factory for Right Angle press fit drawing.

Information including designs, specifications and components may be changed or updated without notice.